

REVJAMS

REV100-BLK



Studio**Lite** Bluetooth
Headphones

USERS MANUAL

Thank you for choosing the **RevJams Studio Lite Bluetooth Headphones** !

Please take the time to read this manual carefully, even if you are already familiar with a similar product.

PACKAGE CONTENTS

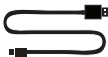

- RevJams Studio Lite Bluetooth Headphones
- Micro USB charging cable
- AUX audio cable
- Users guide

BLUETOOTH HEADPHONE CONTROLS

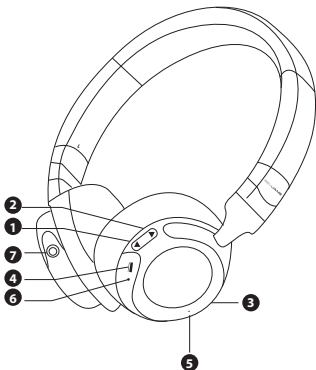

1. Volume - / Previous track
2. Volume + / Next track
3. Multi-Function Button - Power/Play/Pause/Pair
4. Micro USB charging port
5. Microphone
6. LED indicator
7. AUX audio port

LED INDICATOR GUIDE

STATUS	INDICATOR
Power On	Blue light
Power Off	Turn red to power off
Charging	Red light
Bluetooth Pairing Mode	Red and blue light flash alternately
Connected to Bluetooth	Blue LED flashing slowly

GETTING STARTED

To use your RevJams Studio Lite Bluetooth Headphones, please follow the steps below:

1. Ensure your Bluetooth headphones are **fully charged**.
2. Pair your Bluetooth headphones to a Bluetooth-enabled device prior to use. (See **Pairing your Headset** instructions)

CHARGING YOUR HEADSET

Your RevJams Studio Lite Bluetooth Headphones come with a built-in rechargeable battery and a Micro USB charging cable. **Charge fully before use.** The battery indicator will turn red when charging and turn off once charging is complete. Initial charging time is approximately **3 hours**.

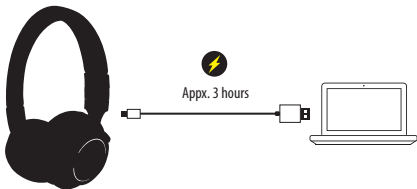

PAIRING YOUR HEADSET

In order to use your RevJams Studio Lite Bluetooth Headphones with a Bluetooth-enabled device, you will first need to pair the two.

1. Begin with the headset being **powered off and fully charged**.
2. Place the headset and the mobile phone where they are easily viewable and no more than 3ft apart.
3. Press and hold the Multi-Function button for approximately **3 seconds**, the red and blue light will flash alternately which indicates that the headphones are in Pairing Mode.
4. Activate your mobile phone's Bluetooth pairing function and select "**Studio Lite**" from the list of devices shown.

When successfully paired the LED indicator will flash Blue

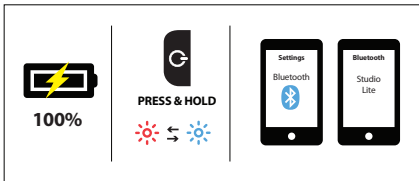

POWERING ON THE HEADSET

Press and hold down the Multi-Function button for **3-4 seconds** until a **BLUE** light appears.



POWERING OFF THE HEADSET

Once powered on, Press and hold down the Multi-Function button until a **RED** light appears to turn off.



CONNECTION WITH THE LAST PAIRED DEVICE

When powered on, the headset will automatically connect with the last successfully paired device.

WEARING YOUR HEADSET

The Left / Right indicator is located on the inside of the headphones band.

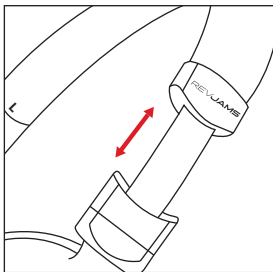

Be sure to adjust the headband so that the ear cups rest comfortably on your ear, only with the right fit will you enjoy a snug fit & premium sound quality

CALL MODE

Answering a Call	Short Press the Multi-Function button once to accept the call, or answer the call normally via your mobile phone.
Rejecting a Call	Press and hold the Multi-Function button for 2 seconds to reject the incoming call.
Ending a Call	Short Press the Multi-Function button to end the call or end the call directly from your mobile phone.
Redialing a Call	Press the Multi-Function button twice to redial the last dialed phone number on your mobile phone.

MUSIC MODE

Adjusting the Volume	Press and hold the Volume + to increase volume or Volume - to decrease volume. You can also adjust the volume on your handset or device
Play/Pause Music	Once connected, Press the Multi-Function button once to play music. Short Press the Multi-Function button to pause music.
Previous Track	Short Press the "Volume -" key to select the Previous track.
Next Track	Short Press the "Volume +" key to select the Next track.

TROUBLESHOOTING

If you are unable to connect your headset and mobile phone, please try the following:

Ensure that your headset is fully charged and powered on.

Ensure that the headset is paired with your mobile phone.

Ensure that your mobile phone's Bluetooth feature is activated. Please refer to your mobile phone user's guide for specific instructions.

Ensure that the headset is within a 30 ft. range of your mobile phone and that there are no obstructions, such as walls or other electronic devices, between the two.

Ensure that there are no other Bluetooth enabled devices paired to your headphones. If this occurs, delete the paired headphones from that device and try pairing and connecting again.

If you are experiencing Bluetooth connection issues - KEEP THE MUSIC DEVICE AT OR ABOVE WAIST LEVEL ON YOUR RIGHT SIDE, THE SAME SIDE AS THE HEADPHONE ANTENNA. Your body is 80% water. Water blocks low power radio signal like Bluetooth. In the absence of nearby ceilings for signal bounce, your body can block the signal between the music device and the headphones. When outdoors or at the gym the use of armbands or wrist-worn music players are recommended. Having your music player

in your pants pocket below waist level may produce varied results as your body can get between the music device & headphones.

CARE AND MAINTENANCE OF YOUR HEADSET

- i. Consider turning your headset off before placing it in your pocket or bag. If the Power button is accidentally activated, your mobile phone may place an unintended call.
- ii. Do not expose the headset to liquid, moisture or humidity, as it is not waterproof.
- iii. Do not use abrasive cleaning solvents to clean the headset.
- iv. Do not expose the headset to extreme temperatures. The best storage temperature range is from 40-80 F, otherwise, the life of the headset will be affected.
- v. Do not dispose of the headset in fire as this may result in an explosion.
- vi. Do not bring your headset into contact with sharp objects as this will cause scratches and can damage the headset.
- vii. Do not attempt to disassemble the headset, as it does not contain serviceable components.
- viii. If you do not use the headset for long periods, be sure to store it in a dry place, free from extreme temperature conditions and dust.

WARRANTY

At RevJams, we are dedicated to making the best quality product. To back this up, your RevJams Studio Lite Bluetooth Headphones are covered by a One (1) Year Limited Manufacturer's Warranty. Details of the warranty are as follows: for a period of one (1) year from the date of retail purchase, RevJams warrants that this product is free of any defects in manufacturing, materials and workmanship. During the warranty period, we shall, at our sole discretion, repair or replace any defective parts within a reasonable period of time.

Please visit our website **www.revjams.com** for more details

Or Email us at: **customerservice@revjams.com** for any questions or concerns about your product.

SAFETY INFORMATION

Check local laws regarding the use of mobile phones and headsets while driving.

If you use the headset while driving, ensure that your attention and focus remains on the road and you drive in a responsible and safe manner.

Never allow children to play with the headset, as the small parts may be a choking hazard.

Observe all signs that require an electrical device or RF radio product to be switched off in designated areas. These could include hospitals, airplanes, blasting areas, and potentially explosive environments.

Never mount or store your headset over an air bag deployment area, a serious injury may result when the air bag deploys.

Do not open or mutilate the built-in battery.

Dispose of batteries according to local regulations.

Do not dispose as household waste.

PRODUCT SPECIFICATIONS

Bluetooth version: 4.1

Frequency 2.402-2.480GHz

Bluetooth mode: HSP HFP A2DP AVRCP

Working range: 33 ft.

Talk/Music time: Up to 20 hours

Standby time: 250 hours

Charging time: About 3 hours

Battery: 400mAh 3.7V Polymer Li-ion Battery

Speaker size: 40mm 110±3dB 20Hz~20KHz

Microphone: 4015 -42+/-3dB 30-16KHZ

Actual performance may vary due to the user's habits, different modes of operation, and mobile phone settings. This manual is for reference purposes only. The specifications and design of the headset may change without prior notice. Actual product may differ slightly from the image on the packaging

WARNING AND PRECAUTIONS

WARNING: To prevent fire or shock hazard, do not expose this unit to rain or moisture.

WARNING: Do not place this unit directly onto furniture surfaces with any type of soft, porous, or sensitive finish. As with any rubber compound made with oils, the feet could cause marks or staining where the feet reside. We recommend using a protective barrier such as cloth or a piece of a glass between the unit and the surface to reduce the risk of damage and/or staining.

WARNING: Lithium batteries, like all rechargeable batteries are recyclable and should be recycled or disposed of in normal household waste. Contact your local government for disposal or recycling practices in your area. They should be incinerated since they might explode.

NOTE: This device uses an internal rechargeable lithium-ion battery that should last the lifetime of the device. If you suspect your battery may be dead after several attempts to charge, please visit www.revjams.com for support.

Never disassemble the unit or attempt to remove the battery as that could cause leakage of an electrolyte substance

FCC WARNINGS

Warning: Changes or modifications to this unit not expressly approved by the party responsible for compliance could void the user's authority to operate the equipment.

NOTE: This equipment has been tested and found to comply with the limits for a Class B digital device, pursuant to Part 15 of the FCC rules. These limits are designed to provide reasonable protections against harmful interference in a residential installation. This equipment generates, uses, and can radiate radio frequency and, if not installed and used in accordance with the instructions, may cause harmful interference to radio communications.

